

Beautiful
TIMBER FRAME & LOG BUILDINGS
Built to your specification

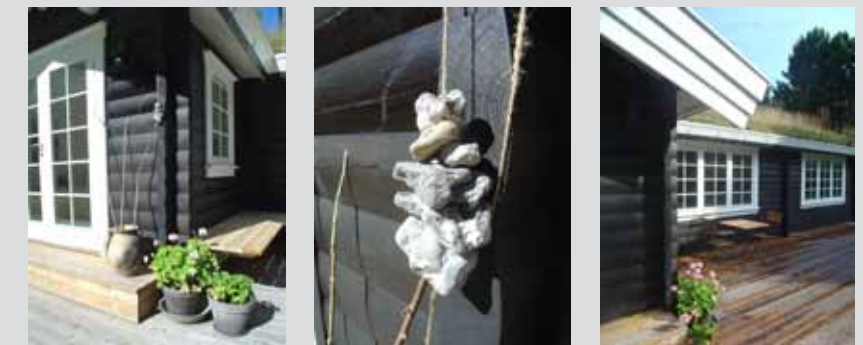

NORDIC WOOD LTD
Abbey House | Wellington Way
Weybridge | Surrey | KT13 0TT
Tel: 01932 268440 | Fax: 01932 325339
www.nordic-wood.co.uk | info@nordic-wood.co.uk

NORDIC ROOM



NORDIC ROOM - A FULLY INSULATED TIMBER FRAME STUDIO

Home office, music studio, gym, teenage-den, treatment/consultation room, home cinema, guest room, pool cabin or a place for dreaming in your garden. The Nordic Room can be configured to provide the high-quality extra space you have been looking for at a remarkably affordable price.

The Nordic Room is built in timber frame, fully insulated, for all-year-round use. The standard room is constructed of a timber frame, externally clad with spruce tongue & groove timber. All rooms come with a 27mm solid pine floor and an internal pine panel, in white wash or natural colour. Upgrade options for external cladding include Siberian Larch and Western Red Cedar.

NORDIC ROOM SIZE RANGE

All sizes are available in both pent or pitched roof

Depth x Width	Depth x Width	Depth x Width
3.09 x 3.70	3.88 x 3.70	5.08 x 4.90
3.09 x 4.30	3.88 x 4.30	5.08 x 5.50
3.09 x 4.90	3.88 x 4.90	5.08 x 6.10
3.09 x 5.50	3.88 x 5.50	
3.09 x 6.10	3.88 x 6.10	

WINDOW & DOORS OPTIONS

- 1490x1950mm double entry door with EU lock and stainless steel handle
- 890x1950mm glass fixed panel
- 990x460mm desk/ventilations window
- Bi-fold and solid entry doors (on request)
- All doors/windows come with pine architraves: Inside 15x70mm and outside 18x95mm
- Handles and locks in stainless steel are included
- Low energy double glazing as standard. 1 U-value 5 YEAR WARRANTY on all windows and doors

Included in standard Nordic Room kit:

One double door, two fixed single glass panels and one airing window. See price list for additions.



BESPOKE TIMBER FRAME BUILDINGS



TIMBER FRAME CONSTRUCTION

A timber frame is constructed by layering wood panels and a number of membranes and insulation onto a timber frame, to create a wall satisfying the UK building standards. Both internal and external claddings can be changed to achieve the right look and feel. These houses are suitable for all year round living. The finishing is up to you, perhaps you want a more traditional look with a round timber profile, with lattice windows? Or maybe you have set your mind on a modern look with flat timber profile and large glass doors and panels? The choice is yours! If you know what you want we can build to your specifications, if you need design help we can do that too.

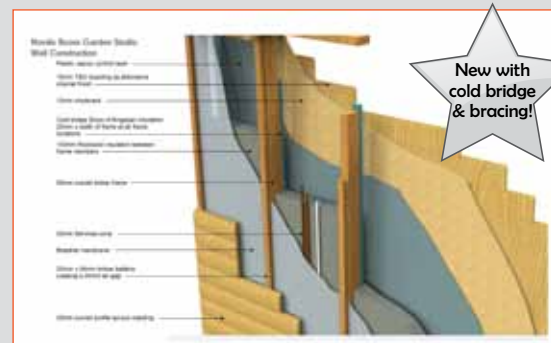

HOUSES FOR LIVING

A timber frame structure is easily adaptable to any structure; The larger the building the more substantial the timber frame and insulation. Please contact us with your plan for pricing.



TRADITIONAL LOG CABINS



BESPOKE CORNER JOINTED LOG CABINS

Nordic Wood has taken up the challenge to offer an alternative to the standard log cabin package you often find on the market. This provides the opportunity for our clients to tailor make their own log cabin floor plan specially suited to their garden design and size. Our sophisticated cutting process at the sawmill enables the wall logs to be cut and packed on an individual basis regardless of size and length whilst taking into account the best use of timber for limited wastage.

We supply a flat profiled pine log in two thicknesses 45mm and 70mm, to suit your needs. All logs come with a double tongue & groove system for a strong and durable build. The floor is a premium 27mm thick pine floor from Sweden. Add insulation in floor and roof and you will have a cabin for all year round leisure use.

Our cabins can be made in pent or pitched roof. Contact us for prices



LAMINATED LOG FRAME "GLULAM"



BESPOKE LAMINATED LOG FRAME STRUCTURES

As an alternative to timber frame we can offer a bespoke cabin constructed with a "Glulam" log as external wall. This enables us to achieve the traditional log cabin look, but also get a very solid structural bearing in the external walls. The Log frame is, apart from the external wall, constructed in the same way as a timber frame to make sure we achieve insulation values required by Building Control. Using a "Glulam" log gives a significant advantage over a traditional full log. The laminated log is much stronger, of higher quality, and has less movement than a full log. We recommend our log frame for live in houses and utility buildings where large rooms and open spaces are required in addition to buildings our client want to achieve the traditional log cabin look. We recommend our log frame for live in houses and utility buildings where large rooms and open spaces are required in addition to buildings our client want to achieve the traditional log cabin look.

All our timber buildings can be insulated up to UK building standard. When purchasing a house from us we will make that the building will pass building control.

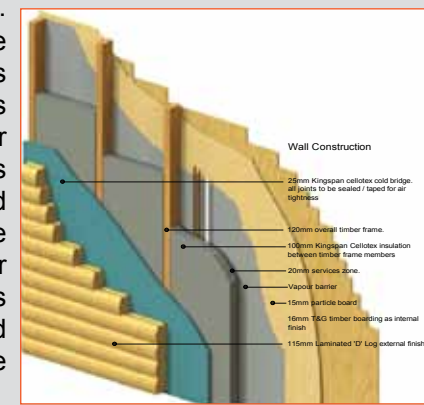

WOOD & THE ENVIRONMENT



- Over 70% of people in the developed world live in timber frame homes.
- In North America timber frame accounts for 90% of all low-rise housing.
- Timber frame is the most popular form of building construction in Scandinavia

ECO FRIENDLY

Timber Frame is a prefabricated construction method, it is faster than conventional bricks and mortar and also more eco friendly. Timber frame homes offer good acoustics, energy efficiency, and are warmer. Wood is reportedly the most energy-efficient of all construction materials. Five hundred kilowatt hours are needed to produce a single cubic metre of steel, 200 kWh are needed for concrete, but only 30 kWh are used for timber.

ENERGY EFFICIENT

Wood houses also use less fuel as the wood is an insulator, absorbing and slowly releasing the heat produced by the energy efficient under-floor heating system, so the boiler is used for much short periods.

SUSTAINABLE FOREST AND THE WOODS NATURAL CYCLE

Wood is the only naturally renewable building material, and the cycle of growth has an added benefit. When a young forest is growing, it produces 1.07 tons of oxygen and absorbs 1.47 tons of carbon dioxide for every ton of wood. When a forest matures this process reduces. Harvesting a mature forest locks in the carbon and planting of new trees increase the process of producing oxygen and absorbing carbon dioxide again.

E.g - A 220 sq. metre timber frame house has about 28.5 tons of stored carbon dioxide which is about the same as a 7 year emission of a small family car.

NORDIC WOOD'S ENVIRONMENTAL PROFILE

- Environmental friendly heating sources as heat pumps and solar panels
- Latest in insulation material such as Celotex and Ecowool
- Energy efficient windows and doors from Denmark



Nordic Wood Ltd is a member of TRADA - The Timber Research and Development Association - is an internationally recognised centre of excellence on the specification and use of timber and wood products.